

Vacant Space Inspection Report

Shopping Center:	EASTRIDGE COMMONS	Date:	6-26-09
Space Number:	C-108	Square Footage:	2,933
Space Address:	37211 LAPEER RD.	Frontage:	27'6"

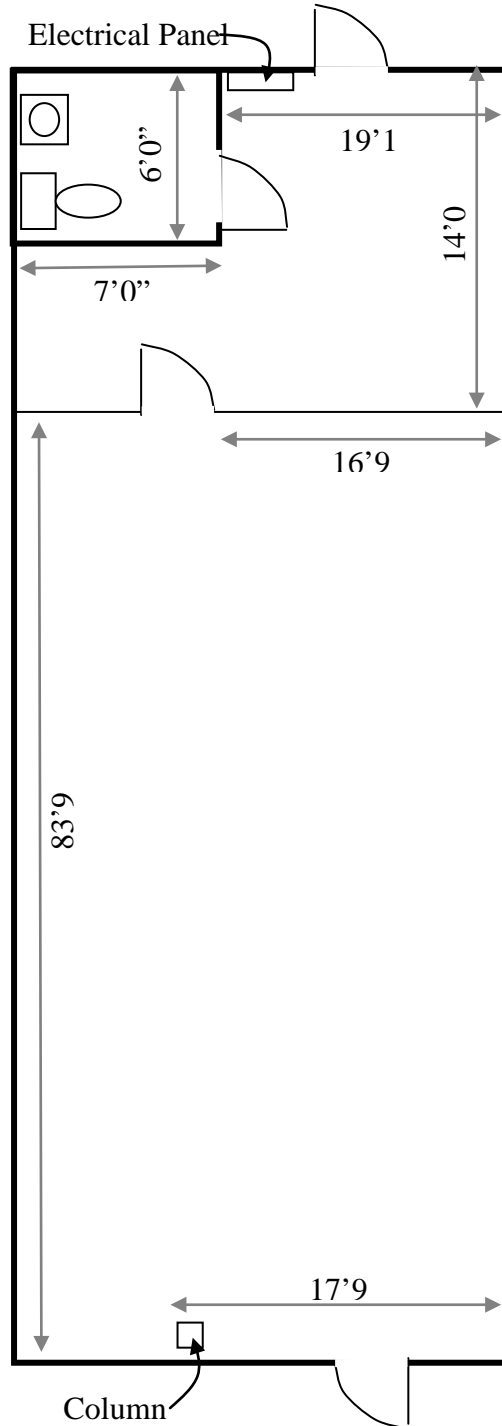

This drawing is illustrative and for informational purposes only. The layout may not be final or to scale and is subject to change without notice. If you are interested in leasing space or affected by the space drawn in any way, you are urged to verify the layout, sizes and other information presented.

Vacant Space Inspection Report

Shopping Center:	EASTRIDGE COMMONS	Date:	6-26-09
Space Number:	C-108	Square Footage:	2,933
Space Address:	37211 LAPEER RD.	Frontage:	27'6"

PHOTOS:





A Subsidiary of
Ramco-Gershenson Properties Trust
(NYSE: RPT)

31500 Northwestern Highway
Suite 300
Farmington Hills, MI 48334
248-350-9900 Phone
248-350-9925 Fax

Vacant Space Inspection Report

Shopping Center:	EASTRIDGE COMMONS	Date:	6-26-09
Space Number:	C-108	Square Footage:	2,933
Space Address:	37211 LAPEER RD.	Frontage:	27'6"

