

Dates:
 FEB. 28, 2007
 FEB. 26, 2008
 APRIL 16, 2010
 JUNE 13, 2011
 NOVEMBER 10, 2011
 FEBRUARY 20, 2012

80' R/W
 OLD GEORGIA HIGHWAY 20
 (AKA McDONOUGH HIGHWAY)

GEORGIA HIGHWAY
 20 & 138

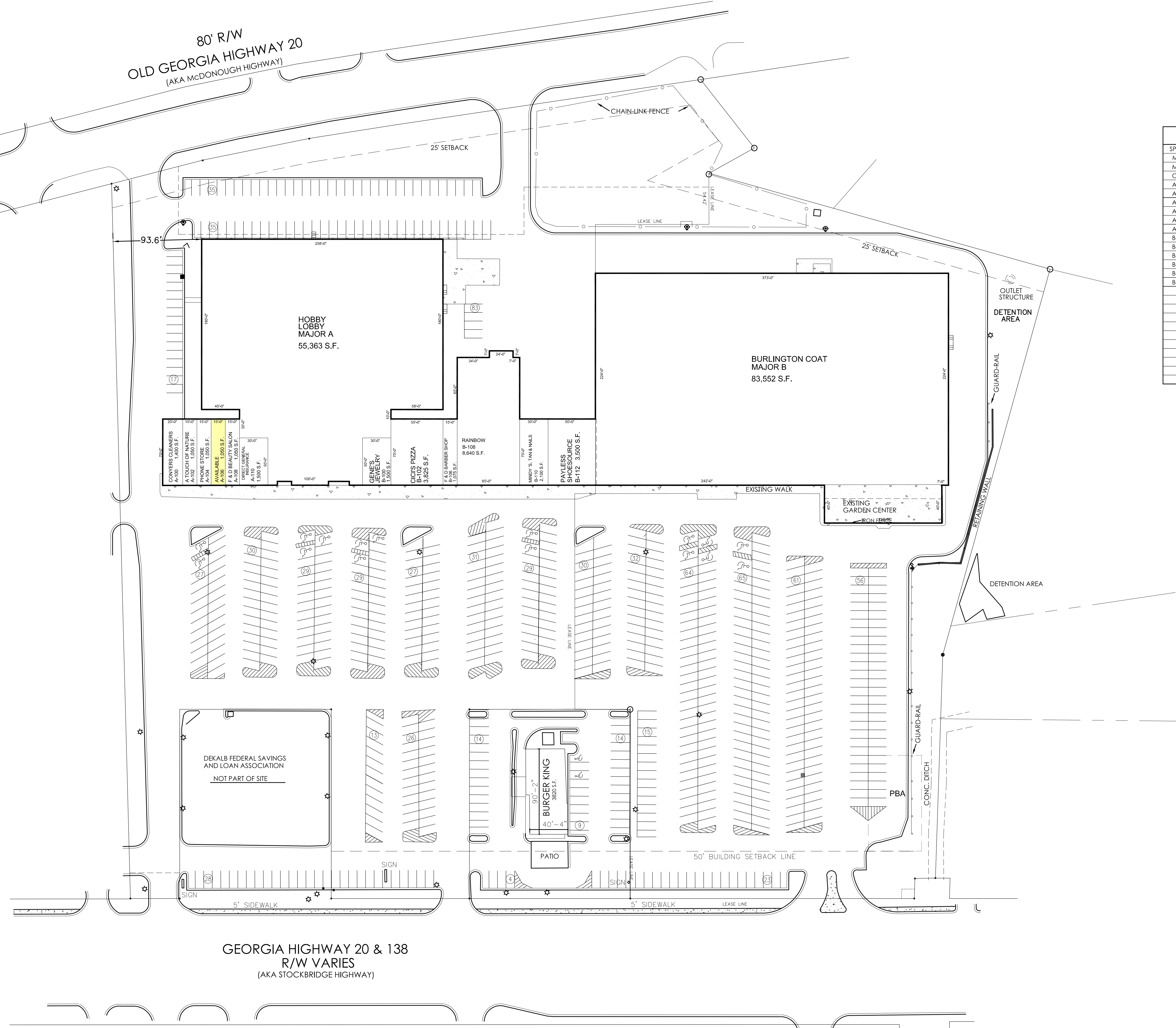

LEASING DATA		
SPACE:	AREA	TENANT:
MAJOR A	55,363 S.F.	HOBBY LOBBY
MAJOR B	83,552 S.F.	BURLINGTON COAT FACTORY
OUTLOT B	3,820 S.F.	BURGER KING
A-100	1,400 S.F.	CONYERS CLEANERS
A-102	1,050 S.F.	A TOUCH OF NATURE
A-104	1,050 S.F.	PHONE STORE
A-106	1,050 S.F.	AVAILABLE
A-108	1,050 S.F.	F & D BEAUTY SALON
A-110	1,500 S.F.	DIRECT AUTO INSURANCE
B-100	1,500 S.F.	GENE'S JEWELRY CENTER
B-102	3,825 S.F.	CICI'S PIZZA
B-104	1,075 S.F.	F & D BARBER SHOP
B-108	8,640 S.F.	RAINBOW
B-110	2,100 S.F.	MINDY'S TAN & NAILS
B-112	3,500 S.F.	PAYLESS SHOESOURCE
TOTALS		
MAJOR A	55,363 S.F.	
MAJOR B	83,552 S.F.	
OUTLOT B	3,820 S.F.	
RETAIL A	7,100 S.F.	
RETAIL B	20,640 S.F.	
TOTAL	170,475 S.F.	
TOTAL PARKING	747 SPACES	
PARKING RATIO	4.38 / 1,000 S.F.	
TOTAL PROPERTY ACREAGE	15,667 A.C.	

GEORGIA HIGHWAY 20 & 138
 R/W VARIES
 (AKA STOCKBRIDGE HIGHWAY)

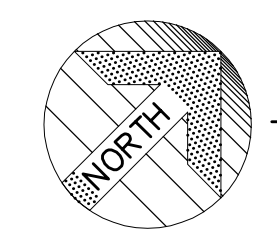

LEASE/SITE PLAN
 1"=50'-0"

Subject
LEASE/SITE PLAN

Project
CONYERS CROSSING
 CONYERS, GEORGIA

DISCLAIMER
 THIS DRAWING IS ILLUSTRATIVE AND FOR INFORMATION PURPOSES ONLY AND SHOULD NOT BE CONSIDERED A CONTRACT. THE LAYOUT MAY NOT BE FINAL. FOR ALL INFORMATION, CONTACT THE ARCHITECT. RAMCO GERSHENSON INC. IS NOT RESPONSIBLE FOR ERRORS OF OMISSIONS AND NO REPRESENTATION OR WARRANTIES ARE EXPRESSED OR IMPLIED BY THIS DRAWING.

RAMCO GERSHENSON INCORPORATED
 1000 WILLOW HILL ROAD
 FARMINGTON HILLS, MICHIGAN 48334
 PHONE: 248.350.9900 FAX: 248.350.9925

Do not scale drawings use figured dimensions

Job Number
2718-99

Sheet Number
LS-4